

## ENCLOSED SWITCH-DISCONNECTORS

100÷160A 3P-3P+N

16÷160A 6P-8P

100÷160A  
3P-3P+N

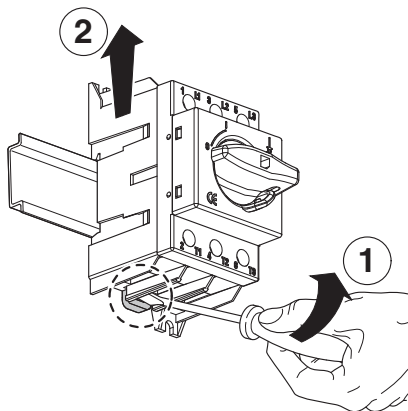
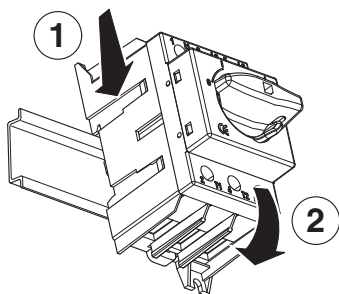

16÷160A  
6P-8P

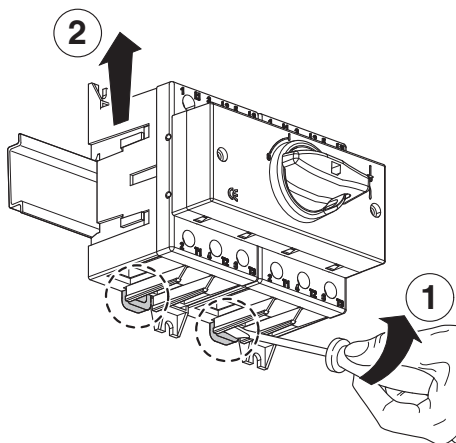
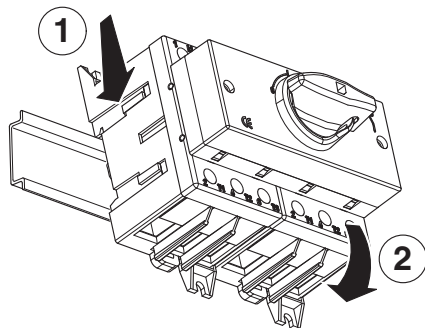

**InfoTECH**

ITALY

WORLDWIDE

Numero Verde

**800-018009**

ScameOnLine

www.scame.com  
infotech@scame.com

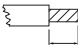
		16÷40A 6P-8P	100A - 3P-3P+N 63-80-100A - 6P-8P	125-160A 3P-3P+N-6P-8P
Wire range		1.5÷16mm <sup>2</sup>	10-50mm <sup>2</sup>	10-70mm <sup>2</sup>
Tightening torque	Terminal screws	2Nm	3.5Nm	6Nm
	Fixing screws	1.2Nm	1.2Nm	1.2Nm
Wire strip length 		10mm	13mm	15mm

3 POLES

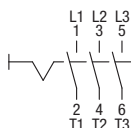

3P+N POLES

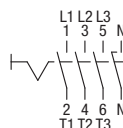

6P POLES

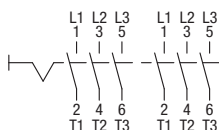

8P POLES

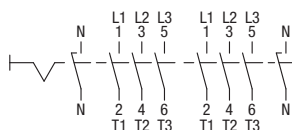
**ATTENTION**

When mounting or removing additional elements the switch **has to be in OFF position** for avoiding damages to mechanism.

When removing main switch following instruction for avoiding damages.

**THERMOPLASTIC ENCLOSURES**

**100A 3P-3P+N  
16÷40A 6P-8P**

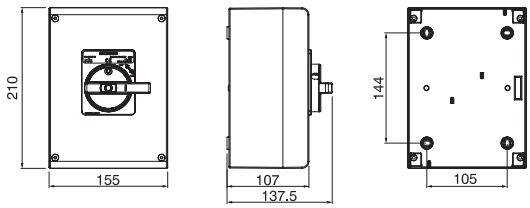

Cable entries		
Top	2xM32	Knock-outs
Bottom	2xM32	Knock-outs
Rear	/	Blank side

**125A 3P-3P+N  
63-80-100A 6P-8P**

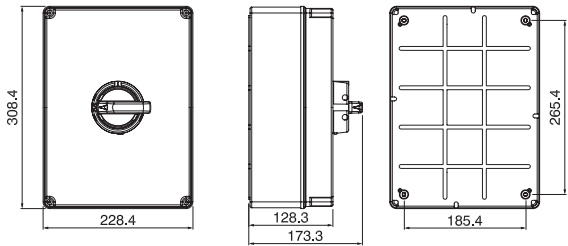

Cable entries		
Top	/	Blank side
Bottom	/	Blank side
Rear	/	Blank side

**125A 6P-8P  
160A 3P-3P+N-6P-8P**

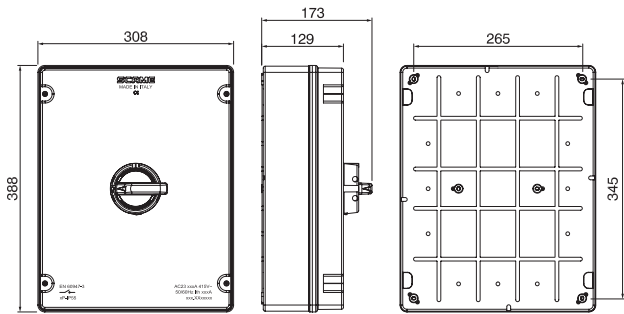

Cable entries		
Top	/	Blank side
Bottom	/	Blank side
Rear	/	Blank side

**ALUMINIUM ENCLOSURES**

**100A 3P-3P+N  
16÷40A 6P-8P**

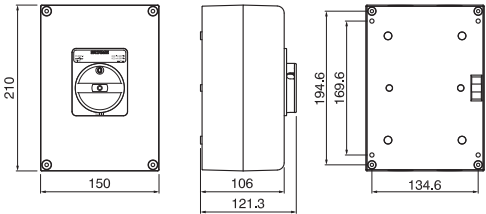

Cable entries		
Top	2xM32	Threaded
Bottom	2xM32	Threaded
Rear	/	Blank side

**125A 3P-3P+N  
63-80-100A 6P-8P**

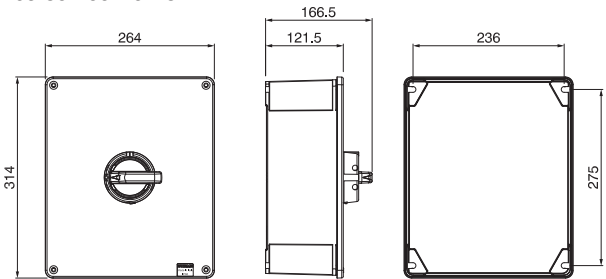

Cable entries		
Top	/	Blank side
Bottom	/	Blank side
Rear	/	Blank side

**125A 6P-8P  
160A 3P-3P+N-6P-8P**

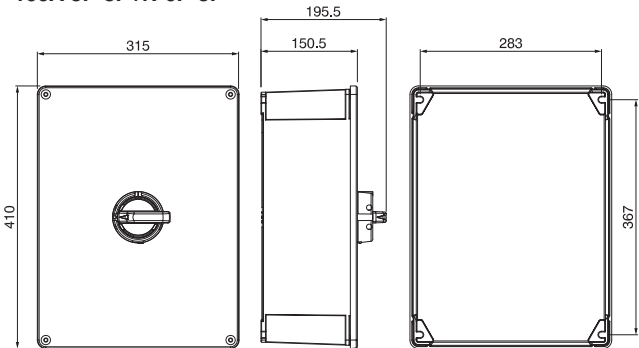

Cable entries		
Top	/	Blank side
Bottom	/	Blank side
Rear	/	Blank side