

200.33233

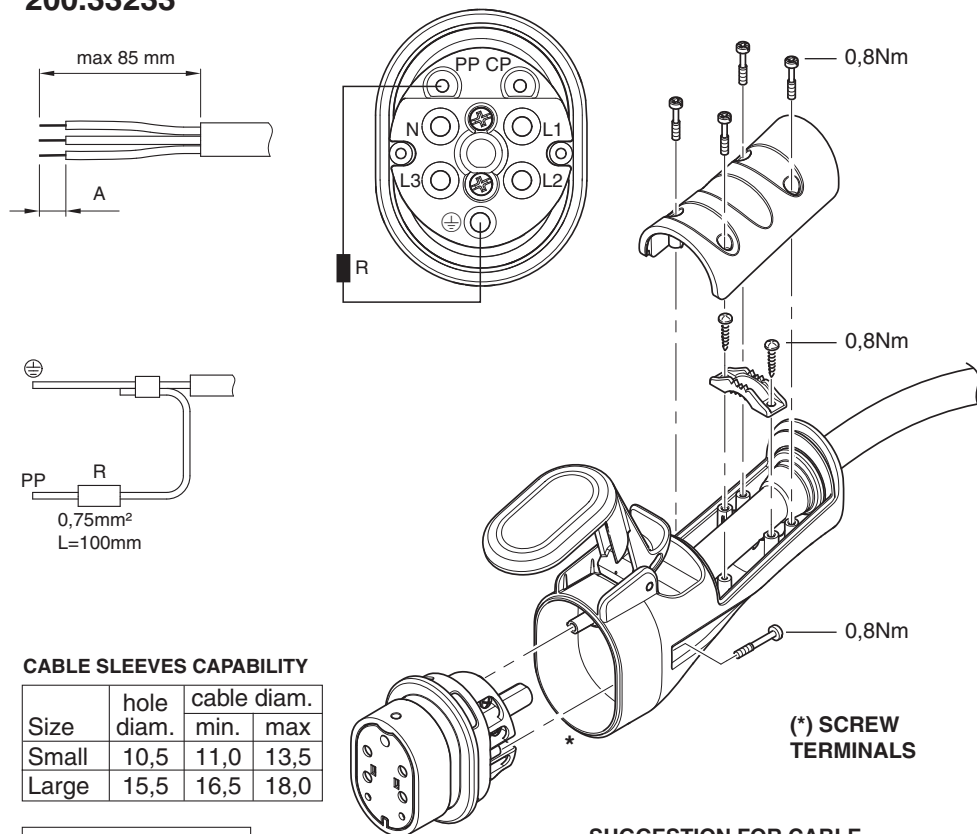

CABLE SLEEVES CAPABILITY

Size	hole diam.	cable diam.	
		min.	max
Small	10,5	11,0	13,5
Large	15,5	16,5	18,0

In	R $\pm 2\%$
13A	1,5k Ω 0,5W
20A	680 Ω 0,5W
32A	220 Ω 0,5W

Description	A	Cross section	Torque
L1	14mm	2,5-6	0,8 Nm
L2	14mm	2,5-6	0,8 Nm
L3	14mm	2,5-6	0,8 Nm
N	14mm	2,5-6	0,8 Nm
⊕	14mm	2,5-6	0,8 Nm
CP	9mm	0,75-1,5	0,4 Nm
PP	9mm	0,75-1,5	0,4 Nm

SUGGESTION FOR CABLE

Type: S05BQ-F or equivalent

Core insulation:

EPR-rubber, crosslinked, type EI6

Outer sheath:

PUR, type TPU flame-retardant

Operating temperature:

-40°C to +90°C

InfoTECH

ITALY

WORLDWIDE

Numero Verde

800-018009

ScameOnLine

www.scame.com
infotech@scame.com

200.33233

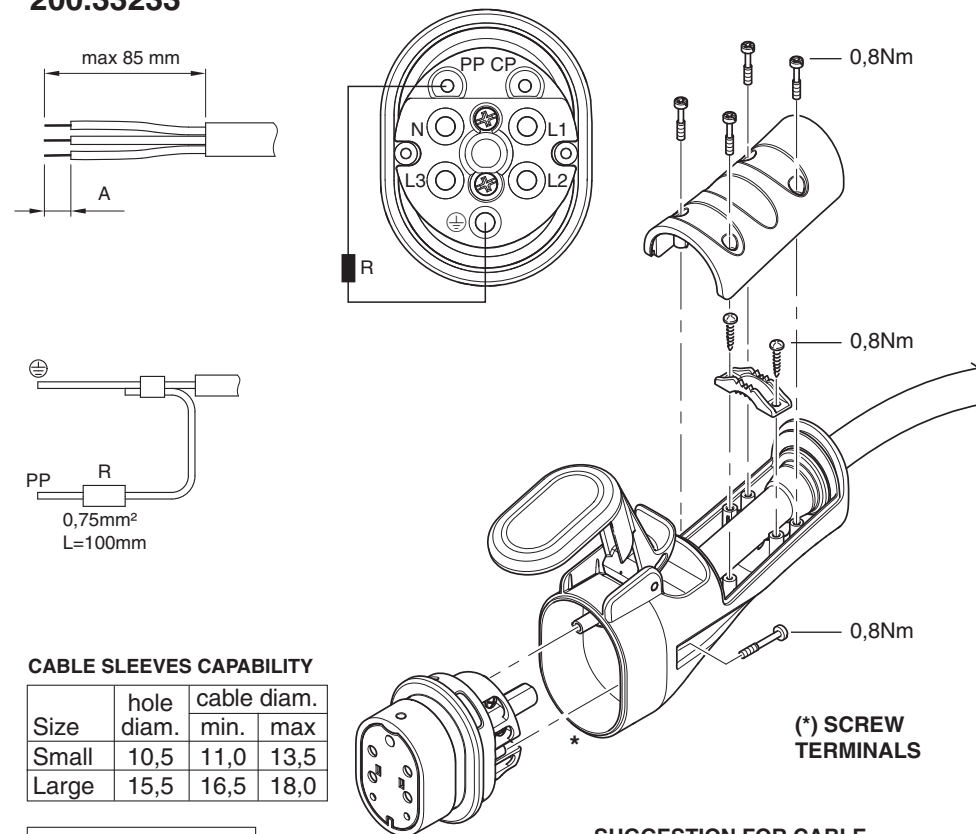

CABLE SLEEVES CAPABILITY

Size	hole diam.	cable diam.	
		min.	max
Small	10,5	11,0	13,5
Large	15,5	16,5	18,0

In	R $\pm 2\%$
13A	1,5k Ω 0,5W
20A	680 Ω 0,5W
32A	220 Ω 0,5W

Description	A	Cross section	Torque
L1	14mm	2,5-6	0,8 Nm
L2	14mm	2,5-6	0,8 Nm
L3	14mm	2,5-6	0,8 Nm
N	14mm	2,5-6	0,8 Nm
⊕	14mm	2,5-6	0,8 Nm
CP	9mm	0,75-1,5	0,4 Nm
PP	9mm	0,75-1,5	0,4 Nm

SUGGESTION FOR CABLE

Type: S05BQ-F or equivalent

Core insulation:

EPR-rubber, crosslinked, type EI6

Outer sheath:

PUR, type TPU flame-retardant

Operating temperature:

-40°C to +90°C

InfoTECH

ITALY

WORLDWIDE

Numero Verde

800-018009

ScameOnLine

www.scame.com
infotech@scame.com